

Technical Data Sheet

CODE 17009

VORTICE LINEO 250 V0

In-line mixed flow fans



Certifications



IMQ



CE



IMQ Performance



C Tick Mark



CCC



EAC

TECHNICAL AND PERFORMANCE DATA

Absorbed power 1st speed (W)	110	Delivery 1st speed (l/s)	275
Absorbed Power max (W)	180	Delivery 1st speed (m ³ /h)	990
Frequency (Hz)	50	Max delivery at max speed (l/s)	375
Insulation Class	II°	Max delivery at max speed (m ³ /h)	1350
IP	44	Pressure - 1st speed (mmH2O)	36
Max ambient temperature for continuous operation (°C)	60	Pressure - 1st speed (Pa)	353,2
Max. absorbed Current at max. speed (A)	0,78	Pressure max - max speed (mmH2O)	53
Max. absorbed Current at min. speed (A)	0,48	Pressure max - max speed (Pa)	519,9
Max. absorbed power at max speed (W)	180	RPM max	2550
Voltage (V)	220-240	RPM min	1900
Weight (Kg)	7	Sound pressure level Lp [dB (A)] 3m - max speed	59,1
		Sound pressure level Lp [dB (A)] 3m - min speed	51,4

DIMENSIONS

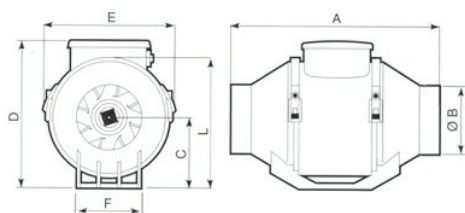

Etichetta Energetica	N0
Size A (mm)	300
Size B (mm)	317
Size C (mm)	385
Size D (mm)	247
Size E (mm)	152,5
Size F (mm)	292
Size G (mm)	176,5
Size H (mm)	140
Size L (mm)	145
Size M (mm)	8

PER INFORMAZIONI:

Servizio al Cliente: tel +39 02 90699395 premendo 1 dopo messaggio registrato (consulenza su prodotti e impianti)

Pre & Post Vendita: fax +39 02 90699302

Email prevendita: prevendita@vortice-italy.com

Technical Data Sheet

CODE 17009

VORTICE LINEO 250 V0

In-line mixed flow fans



DESCRIPTION

- Material: self-extinguishing plastic resin (self-extinguishing capability V0)
- Nominal diameter 250 mm.
- 2 speed AC motor with thermal overload cutout and shaft turning in ball bearings, coupled to mixed flow axial-centrifugal impeller.
- Minimum air flow 990 m³/h
- Maximum air flow: 1350 m³/h
- IMQ SAFETY and IMQ PERFORMANCE certifications
- Vortice speed controllers.

CURVES

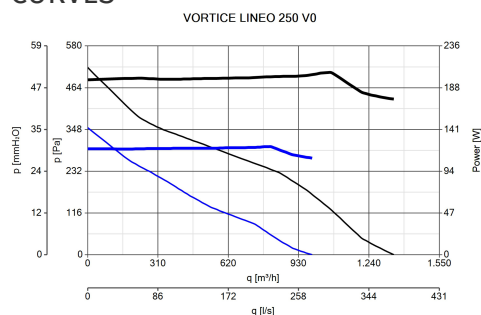

ACCESSORIES

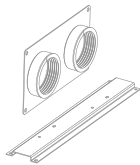

LINEO-PF 250
Code 22583



LINEO-C 250
Code 22589

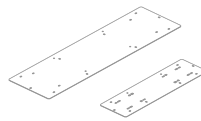

LINEO-SF 700
Code 22594



LINEO-G 250
Code 22706

PER INFORMAZIONI:

Servizio al Cliente: tel +39 02 90699395 premendo 1 dopo messaggio registrato (consulenza su prodotti e impianti)
Pre & Post Vendita: fax +39 02 90699302
Email prevendita: prevendita@vortice-italy.com