

Technical Data Sheet

CODE 17010

VORTICE LINEO 315 V0

In-line mixed flow fans



Certifications



IMQ



CE



IMQ Performance



C Tick Mark



CCC



EAC

TECHNICAL AND PERFORMANCE DATA

Absorbed power 1st speed (W)	200	Delivery 1st speed (l/s)	483,3
Absorbed Power max (W)	300	Delivery 1st speed (m ³ /h)	1740
Frequency (Hz)	50	Max delivery at max speed (l/s)	638,9
Insulation Class	II°	Max delivery at max speed (m ³ /h)	2300
IP	44	Pressure - 1st speed (mmH2O)	43,5
Max ambient temperature for continuous operation (°C)	60	Pressure - 1st speed (Pa)	426,7
Max. absorbed Current at max. speed (A)	1,32	Pressure max - max speed (mmH2O)	75
Max. absorbed Current at min. speed (A)	0,90	Pressure max - max speed (Pa)	735,8
Max. absorbed power at max speed (W)	300	RPM max	2450
Voltage (V)	220-240	RPM min	1780
Weight (Kg)	11,3	Sound pressure level Lp [dB (A)] 3m - max speed	63,4
		Sound pressure level Lp [dB (A)] 3m - min speed	50,6

DIMENSIONS

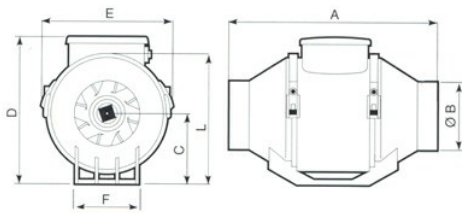

Etichetta Energetica	N0
Size A (mm)	361,5
Size B (mm)	392,5
Size C (mm)	448
Size D (mm)	312
Size E (mm)	188,5
Size F (mm)	359
Size G (mm)	220,5
Size H (mm)	178
Size L (mm)	182
Size M (mm)	8

PER INFORMAZIONI:

Servizio al Cliente: tel +39 02 90699395 premendo 1 dopo messaggio registrato (consulenza su prodotti e impianti)

Pre & Post Vendita: fax +39 02 90699302

Email prevendita: prevendita@vortice-italy.com

Technical Data Sheet

CODE 17010

VORTICE LINEO 315 V0

In-line mixed flow fans



DESCRIPTION

- Material: self-extinguishing plastic resin (self-extinguishing capability V0)
- Nominal diameter 315 mm.
- 2 speed AC motor with thermal overload cutout and shaft turning in ball bearings, coupled to mixed flow axial-centrifugal impeller.
- Minimum air flow 1740 m³/h
- Maximum air flow: 2300 m³/h
- IMQ SAFETY and IMQ PERFORMANCE certifications
- Vortice speed controllers.

CURVES

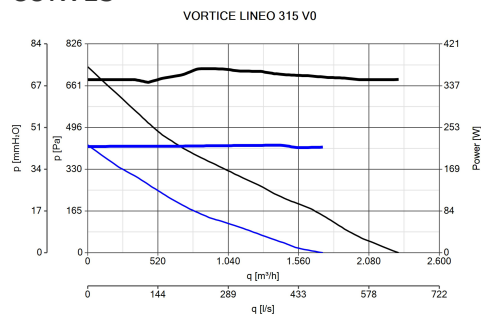

ACCESSORIES



←
LINEO-C 315
Code 22592

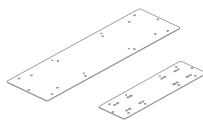

LINEO-SF 700
Code 22594

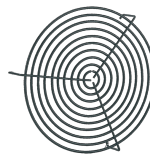

LINEO-G 315
Code 22707

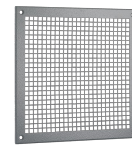

TRA 300
(TELAIO CON
RETE ANTINF.)
Code 51250
→

PER INFORMAZIONI:

Servizio al Cliente: tel +39 02 90699395 premendo 1 dopo messaggio registrato (consulenza su prodotti e impianti)
Pre & Post Vendita: fax +39 02 90699302
Email prevendita: prevendita@vortice-italy.com